

Installation Manual

RENAULT TWINGO 5DR
REN-TWIN-5-B



COMPONENTS INCLUDED

SHADES

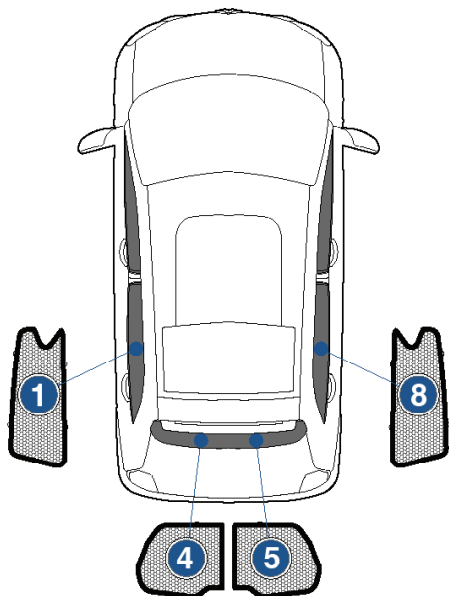

FIXING CLIPS



CL-P02 x 10



CL-M14 x 2



CL-W01 x 1

Side Shade Installation

RENAULT TWINGO 5DR
REN-TWIN-5-B

COMPONENTS NEEDED:



STEP #1

CLEAN THE AREA WHERE CLIPS ARE TO BE MOUNTED (AS IN STEP 2) WITH THE SURFACE CLEANER SACHET PROVIDED



STEP #2

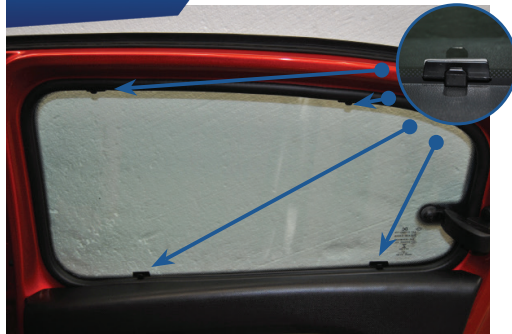

STEP #3

POSITION THE SIDE SHADES

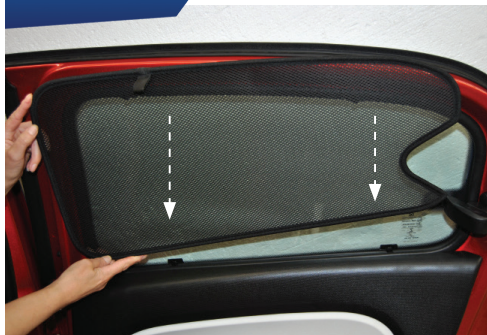

STEP #4

ATTACH THE SHADES TO THE CLIPS



STEP #5

ENSURE SECURELY FITTED IN PLACE



CAR
SHADES

Rear Shade Installation

RENAULT TWINGO 5DR
REN-TWIN-5-B

COMPONENTS NEEDED:

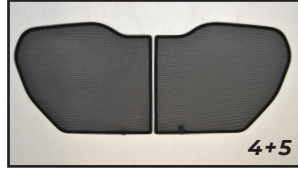

STEP #1

CLEAN THE AREA WHERE CLIPS ARE TO BE MOUNTED (AS IN STEP 2) WITH THE SURFACE CLEANER SACHET PROVIDED



STEP #2

PRESS THE CLIPS FIRMLY INTO PLACE AND ALLOW TO DRY FOR 20 MINUTES



STEP #3

POSITION THE REAR SHADES

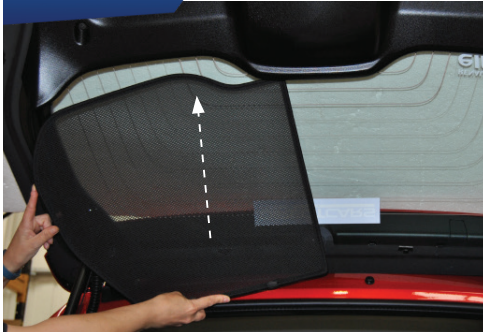

STEP #4

INSERT CLIPS BEHIND INTERIOR TRIM

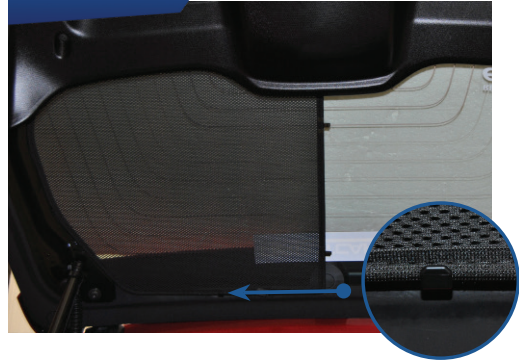

STEP #5

REPEAT THE PROCESS ON OTHER SHADE

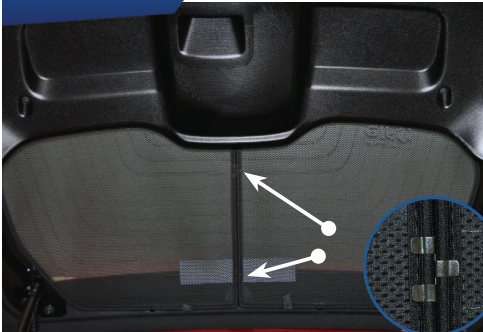

STEP #6

ENSURE SECURELY FITTED IN PLACE

